

BXL1 XL-21

配电箱
Distribution Box



产品概述

BXL1、XL-21 系列动力配电箱适用于电压 380V，容量为 0.52~75kW 电机的电控装置及照明之用。是配电系统的末级设备。配电箱是按电气接线要求将开关设备、测量仪表、保护电器和辅助设备组装在封闭或半封闭金属柜中或屏幅上，构成低压配电装置。正常运行时可借助手动或自动开关接通或分断电路。故障或不正常运行时借助保护电器切断电路或报警。借测量仪表可显示运行中的各种参数，还可对某些电气参数进行调整，对偏离正常工作状态进行提示或发出信号。常用于各发、配、变电所中。

Product Summary

BXL1 XL-21 series power distribution box can be used for electrical control device of 380V rated voltage, 0.52~75kW motors and lights. They are the final device of distribution system. Distribution box are assembled into metal panel or box with switches, measuring instructions, protection components and aux. device according to the requests of electrical wirings. The distribution box can be auto or manual operating to on/off the circuit when normal operating. The distribution box can cut the circuit or alarming with protection components when fault or non-normal operating. The measuring instructions can provide various types of data when operating, and also adjusting some electrical data, and also can indicating or providing signal when deviating normal operating. Commonly used in power supply, distribution, and substations.

环境条件

- 1、海拔高度：≤ 2000m
- 2、相对湿度：≤ 90%
- 3、环境温度：-15 ~ +45 摄氏度
- 4、工作环境：室内或室外安装
- 5、无剧烈振动与冲击
- 6、无强电磁干扰
- 7、无严重扬尘，无易燃、易爆、易腐蚀气体、导电尘埃、无严重霉菌。

Environmental Conditions

1. Altitude: No more than 2000m.
2. Relative Humidity: Average humidity no more than 90%.
3. Ambient Temperature: No more than +45℃, No less than -15℃.
4. Operating Conditions: Indoor & outdoor installation.
5. No vibration impact and shock.
6. No strong electromagnetic interference.
7. No fire, explosion danger, serious dirt, chemical corrosion and violent vibration for product installed place.

产品特点

1. 和谐美观的颜色搭配。
2. 标准化设计，结构紧凑，通用性强。
3. 三维尺寸可按需求变化。
4. 别具特色的眉头设计。
5. 柜门可开启 180°
6. 电气安装板可单独拆卸。

Product Features

1. Harmonious and beautiful colors.
2. Standardized design, compact and flexible structure.
3. 3D demission in adapting requirement variety.
4. With unique characteristic of logo design.
5. Doors can be 180° opened.
6. Electrical installation plate can be separately removable.

技术参数

序号 Sr	名称 Content	单位 Unit	数值 Value
1	额定工作电压 Rated Operating Voltage	V	380/690
2	额定绝缘电压 Rated Insulated Voltage	V	660/1000
3	额定频率 Rated Frequency	Hz	50
4	最大工作电流 Max. operating Current	A	≤630
5	Imin 辅助回路工频耐受电压 Aux. circuit Frequency Withstand Voltage in 1min	kV	2
6	额定脉冲耐受电压 Rated Impulse Withstand Voltage	kV	8
7	防护等级 Protect Degree	IP	IP55
8	电气间隙 Electrical Clearance	mm	20
9	爬电距离 Creepage Distance	mm	≥12.5

Technical Parameters

开关柜结构尺寸示意图

外型尺寸 Overall Dimensions	挂墙 Wall-hung	落地箱 Console
宽度 Width	300-800	600-1200
高度 Height	400-1200	1600/1800/2000/2200
深度 Depth	160/180/200//250	400-800

Structure Dimension and Sketch

BXL1、XL-21 (落地箱) BXL1, XL-21 (Console)			
	外型尺寸 Overall Dimensions	安装尺寸 Installing Dimensions	电缆孔尺寸 Cable Hole Dimensions
宽度 Width	W 600-1200	W1 W-200	W2 W-200
深度 Depth	D(不含门厚) D(Without Door) 400-800	D1 D-50	D2 D-130

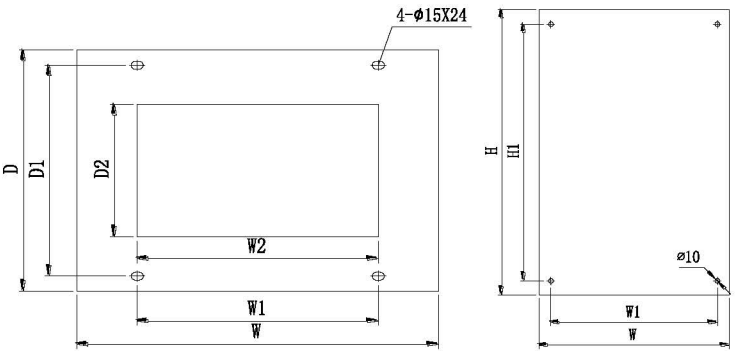

落地箱底部安装基础及电缆出线孔
Console Bottom Mounting Basic and Cable Outlet Hole

挂墙箱（底部安装）
Wall-hung Distribution (Bottom Mounting)

BXL1、XL-21 (挂箱) BXL1, XL-21 (Wall-hung)		
	外型尺寸 Overall Dimensions	安装尺寸 Installing Dimensions
宽度 Width	W 300-800	W1 W-50
深度 Depth	H 400-1200	H1 H-60

注：必要时可根据实际情况调整箱体尺寸。
Notes: Adjust the dimension of the distribution when necessary.